

WINDOW INSTALLATION - INSTRUCTIONS

1. Peel off protective film from the foam tape on both pieces (Figure 1).
2. Install frame in wall opening as shown in cross section (Figure 2).

***NOTE:** See Figure 3 for multiple windows installation in a single opening.

3. Before installing the cold side frame, make sure the warm side is leveled using shims if needed (Not included).
4. Fix frame to wall by using 1-1/2" or longer self-drilling screws (Not included) through frame mounting holes.

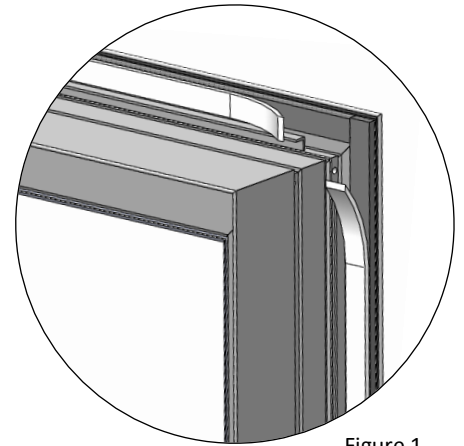

Figure 1

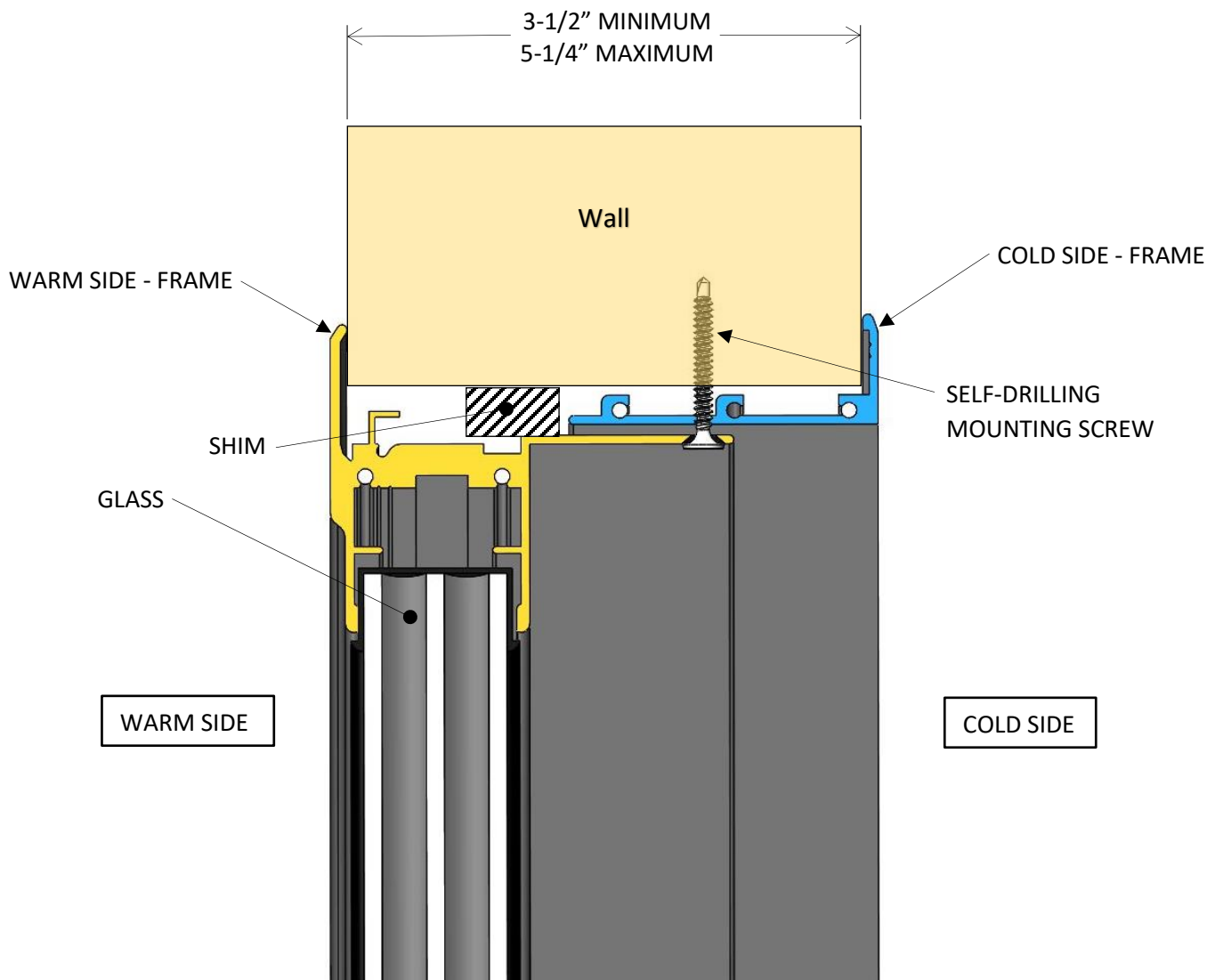

Figure 2

Energy Door Company

180 Arboit Street • L'Assomption • Quebec • J5W 4P5 • CA
www.energydoorco.com

220-10043-0100 Rev : B 21-10

Spare parts – Questions
☎ 1-844-433-0332

- Two windows or more can be installed in a single opening by adding divider boards (Sold separately) between them.

***NOTE:** 1-11/16" per divider board(s) must be added to net opening width.

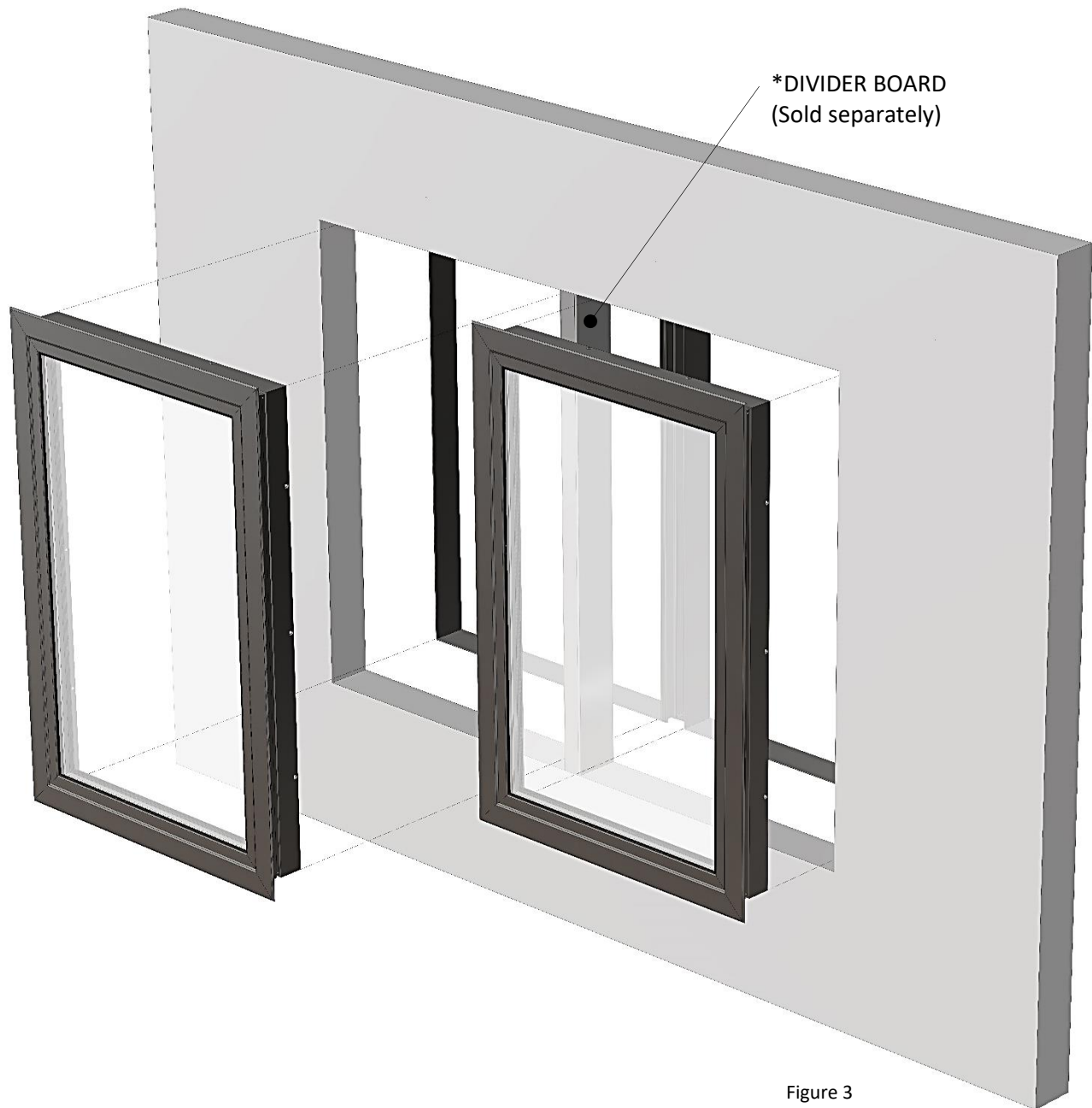

Figure 3